

LOCKLY GUARD™

FOR COMMERCIAL USE & PROFESSIONAL INSTALLATION

WWW.LOCKLYPRO.COM

PGD698D



VISION DUO (698D) INTERCONNECTED EDITION

INSTALLATION GUIDE



Intertek

(application in progress)

GET THE MOST OUT OF YOUR LOCKLY GUARD™

Get the latest **user/installation manuals** , instructional videos, and FAQs

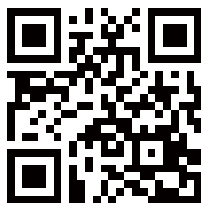

SCAN or VISIT
Locklypro.com/698D

Welcome!

This guide will walk you through step-by-step how to install and get Lockly Guard™ up and running. Installation generally takes less than 30 minutes. If you have any questions please call our VIP hotline (855) 562-5599 for help.

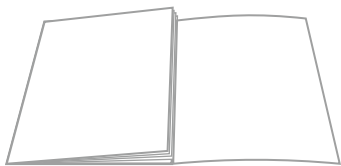

Reference installation parts overview foldout on back page

Preparation

To complete the installation you will need:

Phillips Screwdriver

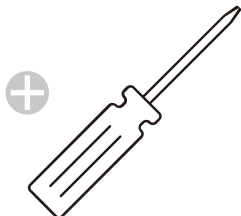

Flathead Screwdriver

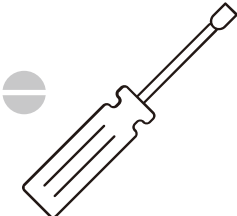

Tape measure or ruler

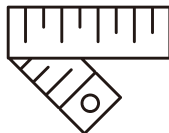

Optional

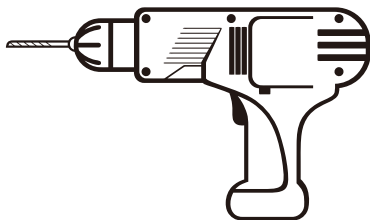

Screwdriver with drill bits

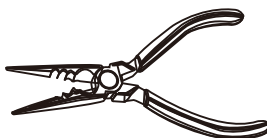

Pliers

Drilling maybe required to install this lock. If you are installing your lock on a brand new door, a drill is required if there are no holes prepared for lock installation. Use provided template to bore holes on door.

Preparation continued

Remove existing door hardware, latch or deadbolts before installing the new lock. **Use provided template to bore new holes if needed.**

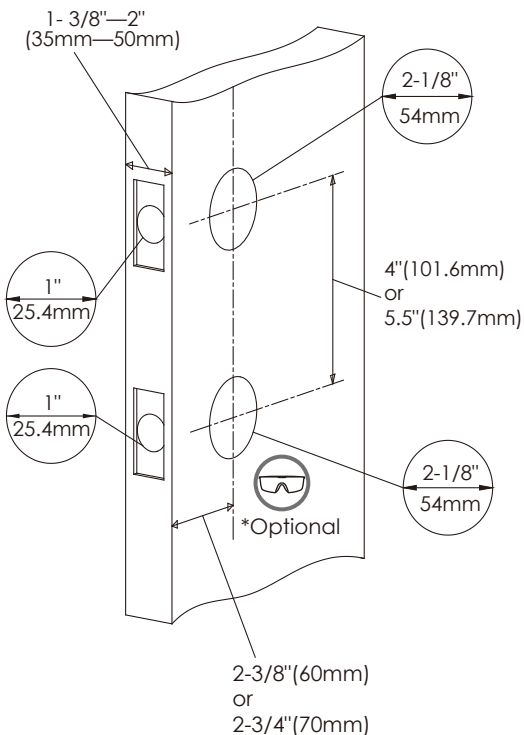

- 1** Measure and confirm your door is between $1\frac{3}{8}" - 2"$ (35mm - 50mm).
- 2** Measure and confirm the hole in the door is $2\frac{1}{8}"$ (54mm).
- 3** Measure and confirm that the backset is between $2\frac{3}{8}"$ (60mm) to $2\frac{3}{4}"$ (70mm).
- 4** Measure and confirm that hole in the door edge is 1" (25mm).
- 5** Measure and confirm that distance between front door holes is 4" (101.6mm) or 5.5" (139.7mm).



IMPORTANT NOTICE

* Use goggles to protect eyes if you need to drill door holes.

- 1 Measure the distance between center of front door hole to the edge of your door hole to determine the backset. Adjust latchbolt **F** and deadbolt **J** according to the backset of your door.

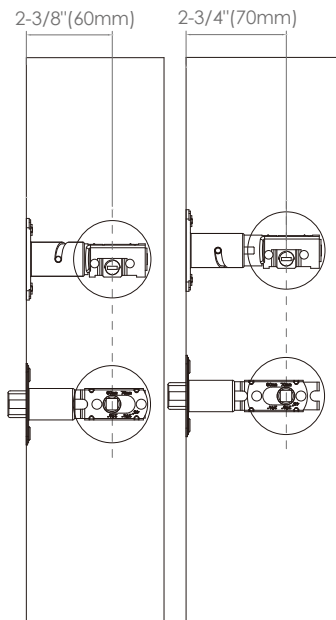

Deadbolt Adjustment **J**

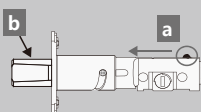

I. Push the crank (a) to extend the deadbolt (b)

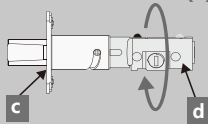

II. Hold the metal plate (c) and twist the deadbolt body (d) clockwise till it snaps to 2-3/8"

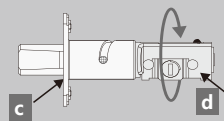

III. To return to default status, while the deadbolt (b) is extended, hold the metal plate (c) and twist the deadbolt body (d) counter-clockwise till it snaps to 2-3/4"



Latchbolt Adjustment **F**

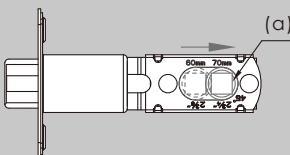

Push the shaft (a) to adjust the lockset to 2-3/8" (60mm) or 2-3/4" (70mm).

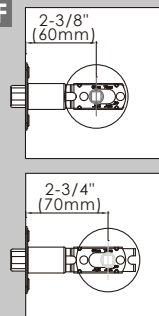

Note: the shaft's horizontal and vertical alignment must be sustained during installation to ensure latch will fully extend and lock securely.

- After adjusting the latchbolt **F**, determine the orientation of the latchbolt. Determine the orientation of latchbolt. Facing the door exterior, install the latchbolt according to the opening direction of your door.

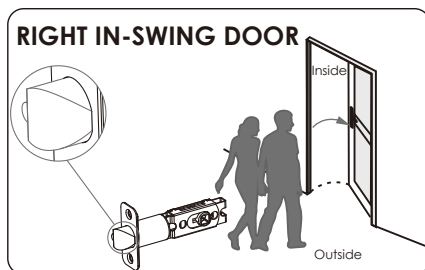
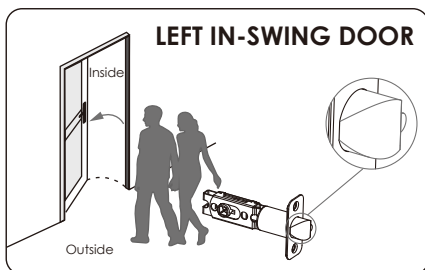
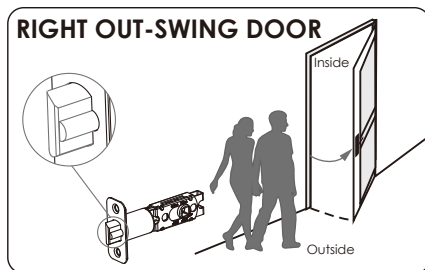
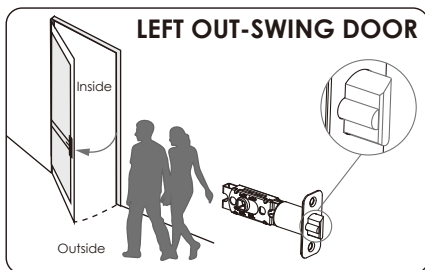

- Install deadbolt **J** (top) and latchbolt **F** (bottom) to door and secure with screws **K** and **G**. Retract deadbolt, make sure bore hole is horizontally positioned and the spindle shaft is centered.

PGA018



5.5"

PGA019



4"

PGA019S



For mortise slot

Optional: Stainless steel mortise slot cover, 4" or 5.5" Face Plates available. To purchase, please call our Customer Service hotline (855) 562-5599 or email prosales@Lockly.com

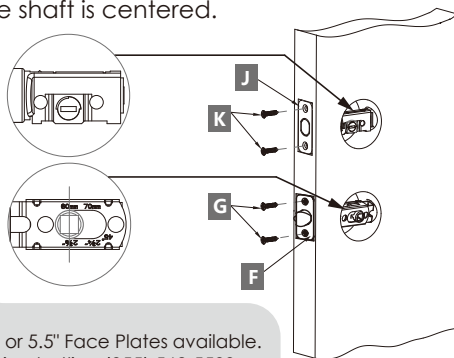

Step 2

CHANGING HANDLE FOR RIGHT OR LEFT SWING DOORS

The lock ships with handle default for right in-swing or left out-swing door. Check the diagram below if you are unsure of your door orientation.

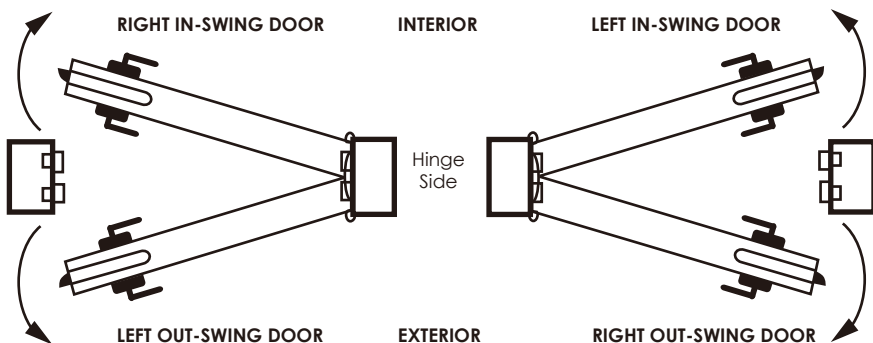

No need to change door handle orientation. Skip Step 2.

LEFT-IN SWING and RIGHT OUT-SWING DOORS require changing the door handle orientation. Continue to follow Step 2 to change exterior and interior door handle orientation.

Changing the Exterior Handle Orientation

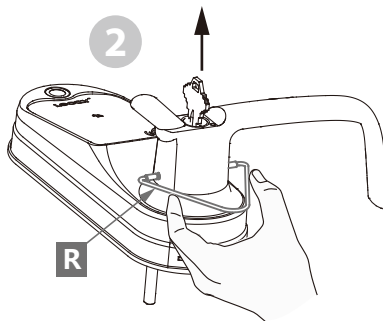
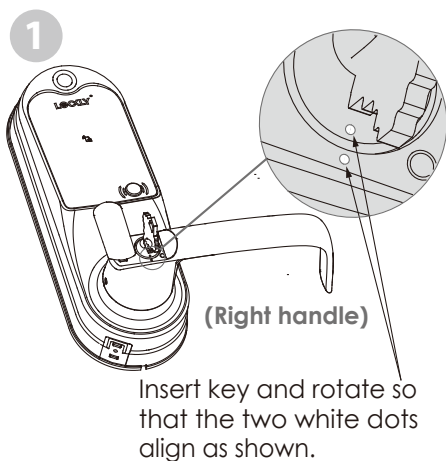

Use the provided pin insert **R** to push the metal pin located at the 3 o'clock of the the base handle, then the other pin at 9 o'clock position. Remove the handle once the pins are compressed.

Step 2 continued CHANGING HANDLE FOR RIGHT OR LEFT SWING DOORS

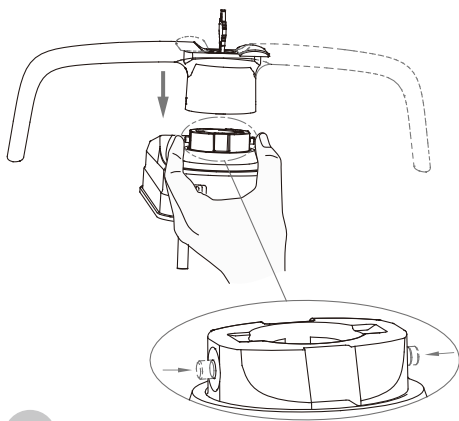

3

Rotate the handle 180° to the other side of the lock.

Using your fingers, press the two pins located on the left and right side of the lock to insert the handle back onto the lock.

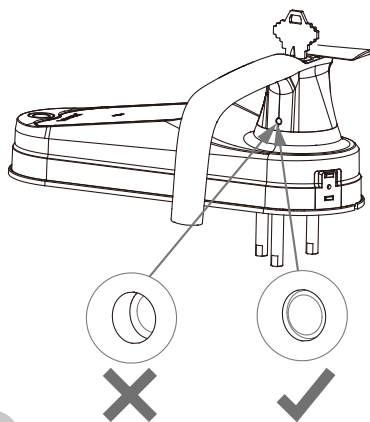

4

Confirm that your installation was complete by checking if the pins are flush against the handle, and has popped out. Adjust the handle accordingly to make sure the pins are fully decompressed and sits flush against the surface.

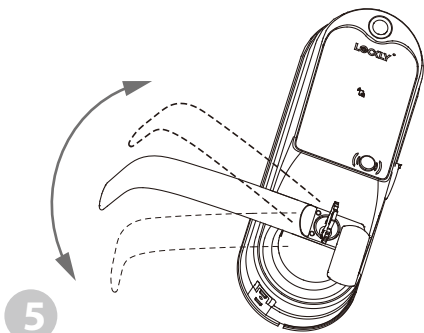

5

Check that your handle works smoothly by giving it a turn up and down.

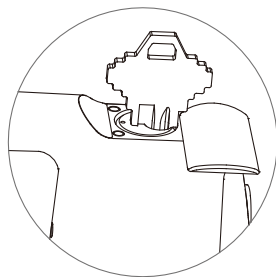

6

Twist key back to horizontal position. The key can be taken out once it goes back to the horizontal position.

- 7** At the back of the exterior assembly, remove the screw on point "R".

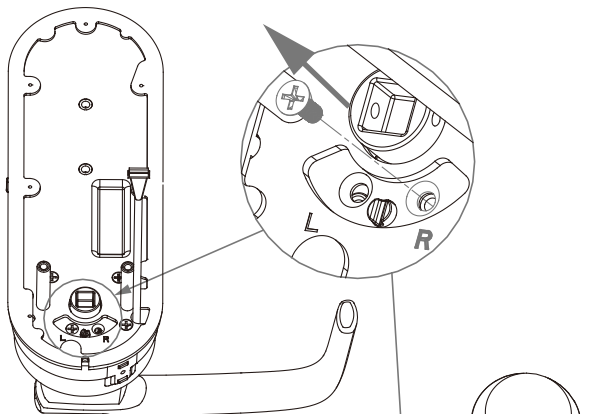

- 8** Align the screw hole on point "L" then insert the removed screw and tighten.

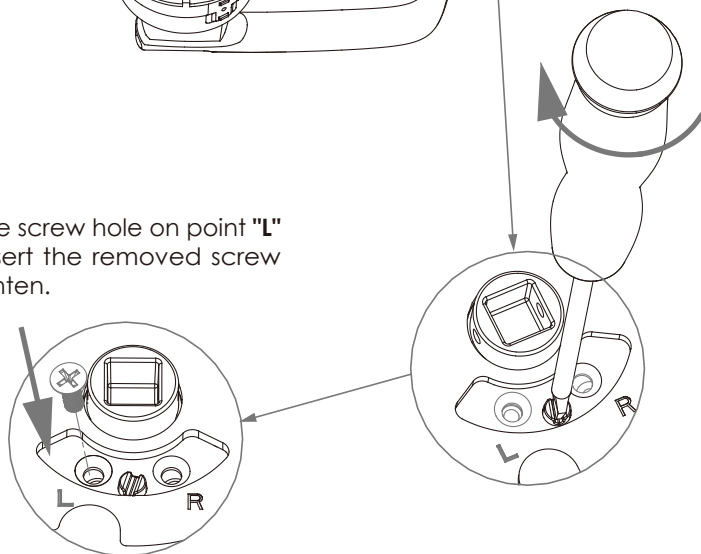

Changing the Interior Handle Orientation

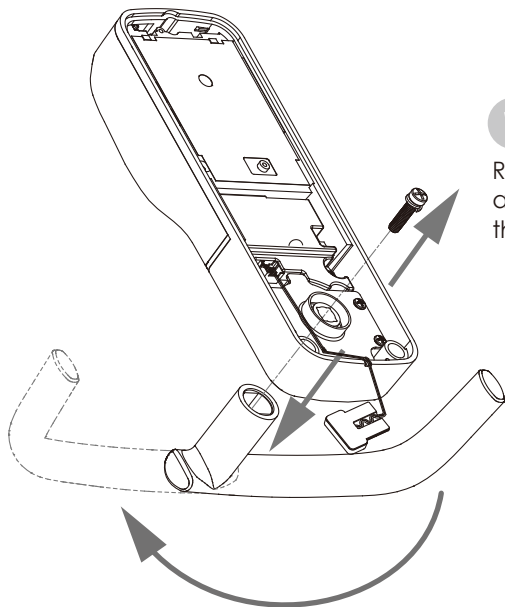

1

Remove the handle retaining screw and detach the handle. Rotate the handle 180° as shown.

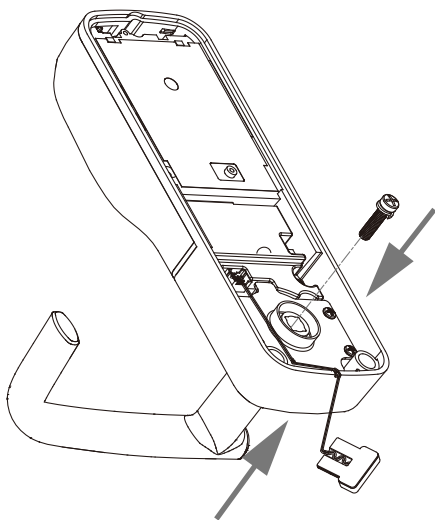

2

Insert the handle retaining screw and tighten using a screw driver.

Step 3

PREPARING LOCK FOR INSTALLATION

Carefully prepare the lock and ensure the required parts (**C** , **D** , **E**) have been properly attached before installing to door.

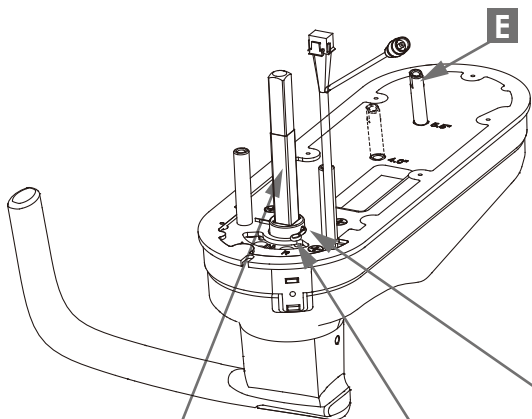

1

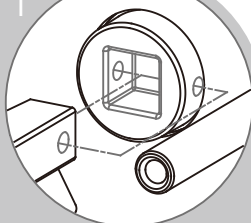

Install Spindle **C** with the holes side into the base of the lock and align the holes locate in the 3 o'clock and 9 o'clock position.

2

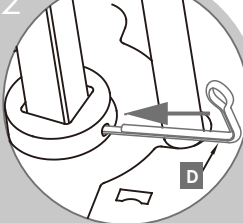

Insert locking pin **D** in to the hole as shown above.

3

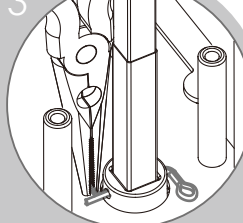

Carefully bend the end of the locking pin **D** with a needle nose pliers.

Failure to bend the locking pin and turn the handle freely without obstruction will result to malfunction.

4

Slotted Barrel Extension **E** should be installed according to upper door hole distance to the bottom door hole (4" or 5.5"). Use a flathead screwdriver to secure tighten **E** clockwise.

Step 4

INSTALLING THE LOCK (EXTERIOR)

- 1 Install fire shield **N1** as shown.

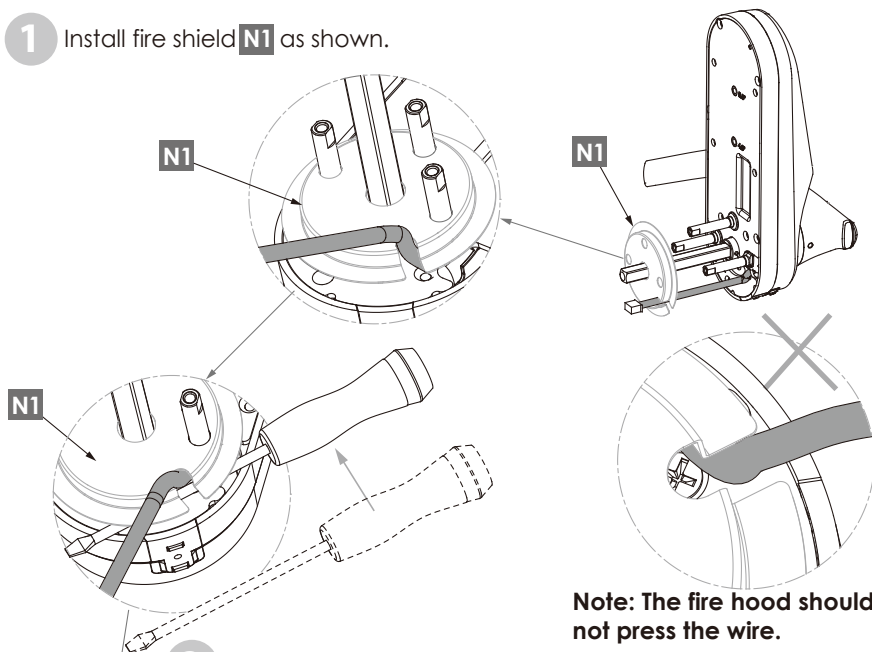

- 2 Use a screwdriver to secure the cables in the fire hood. Ensure that the cables are routed out of the U-shaped slot and the fire hood does not press cables.

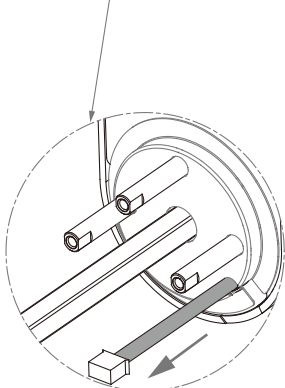

- 3 Pull the connecting wire in the direction of the arrow.

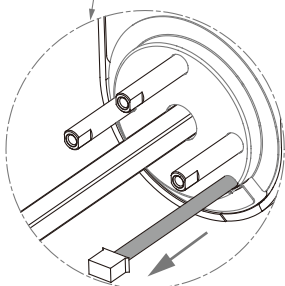

- 4 Install the fire shield **N2** on the outside of the door, on the deadbolt **J**.

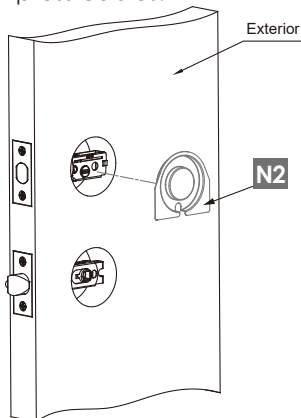

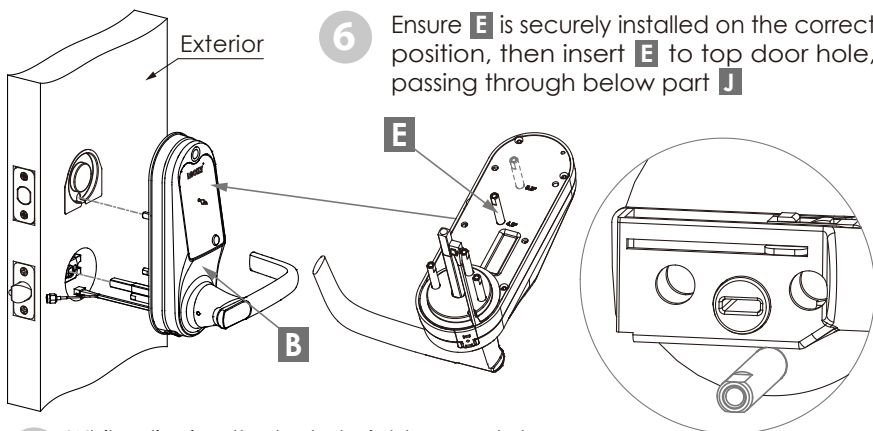

- 6** Ensure **E** is securely installed on the correct position, then insert **E** to top door hole, passing through below part **J**

- 5** While aligning the lock straight up-and-down, pass the wiring cable under the latchbolt **F** then ensure the Slotted Barrel Extension **E** passes through the hole on the lower part of the deadbolt **J** body as shown.

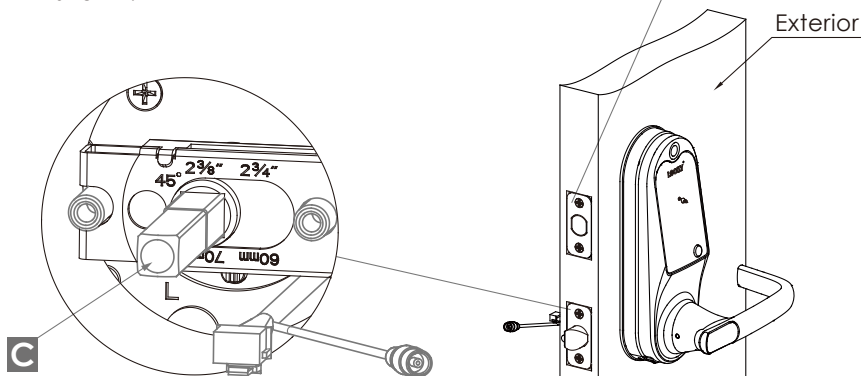

- 7** Pass the spindle **C** through the center of the latchbolt, and the round rods through the sides in their respective holes. **The cable should run underneath the lockset.**

- 8** Check lock alignment and ensure that it is sitting flat and aligned straight.

Step 5

INSTALLING INTERCONNECTION PLATE GEAR

- 1 Select interior cover plate **U1** or **U2** according to door hole distance and install on to door.

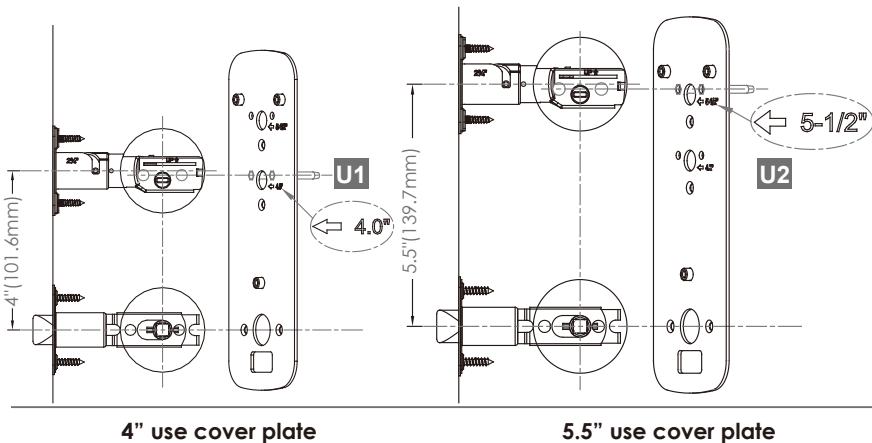

- 2 Insert Positioning Rods **V** into the holes to the left and right of the Spindle **C**. The holes are located at the 3 o'clock and 9 o'clock positions.

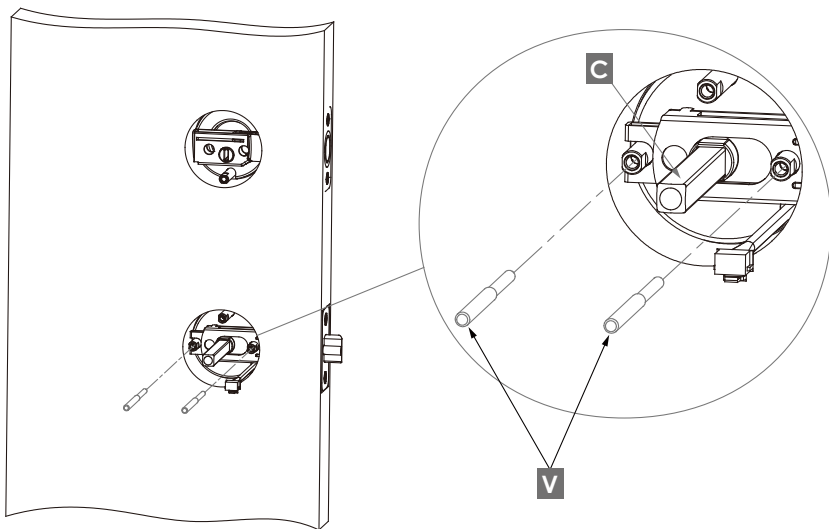

- 3 Install fire shield **N1** as shown. Ensure that the cables are routed out of the U-shaped slot and the fire hood does not press cables.

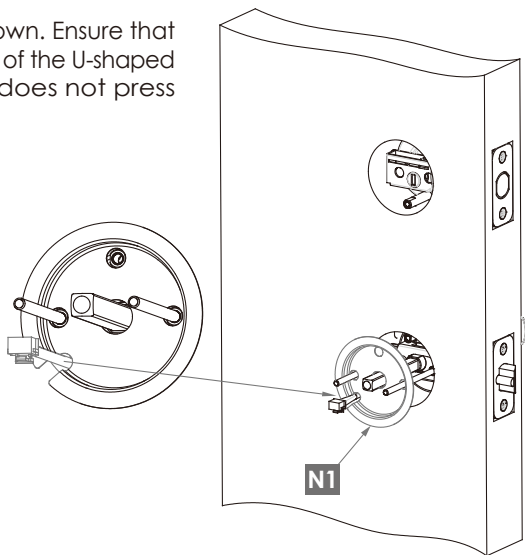

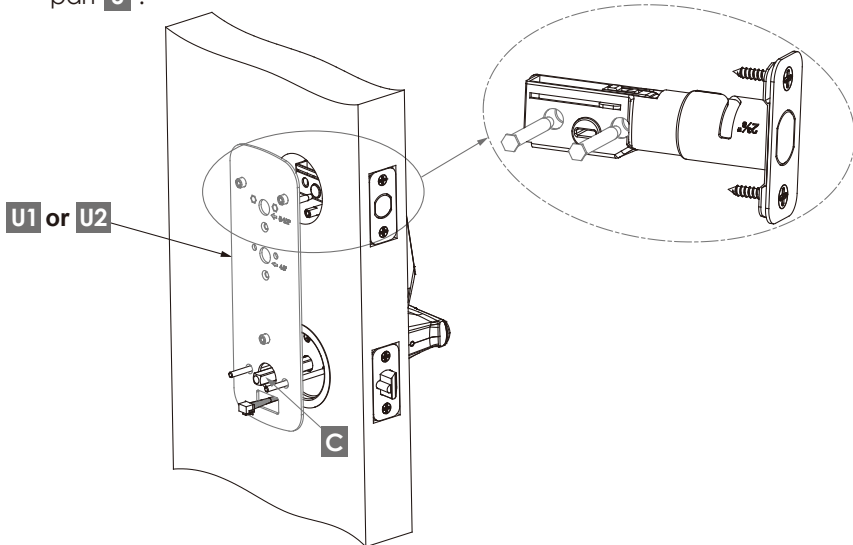

- 4 Ensure the rods on interior cover plate **U1** or **U2** is inserted on the holes of the deadbolt, and the cable and spindle **C** passed through part **U**.

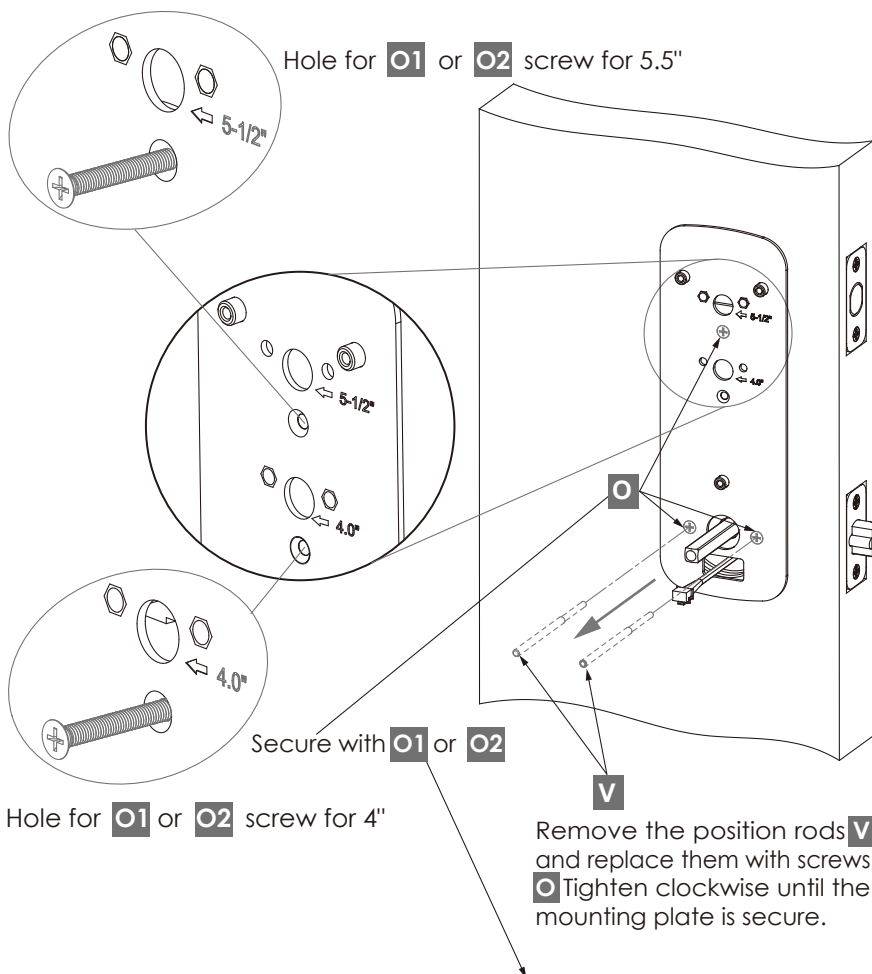

- 5 Secure interior cover plate **U** with screws **O**. Remove the position rods **V** and replace them with screws **O**. Tighten clockwise until the mounting plate is secure.



- O1**  KM4 x 25mm, for door thickness, 1-3/8"~1-2/3"(35~43mm)
- O2**  KM4 x 32mm, for door thickness, 1-2/3"~2"(43~50mm)

- 6** Select the side of the interconnection gear **P** according to door handle orientation **Left** or **Right**. Insert torque blade **AD** to plate according the distance between the latchbolt and deadbolt.

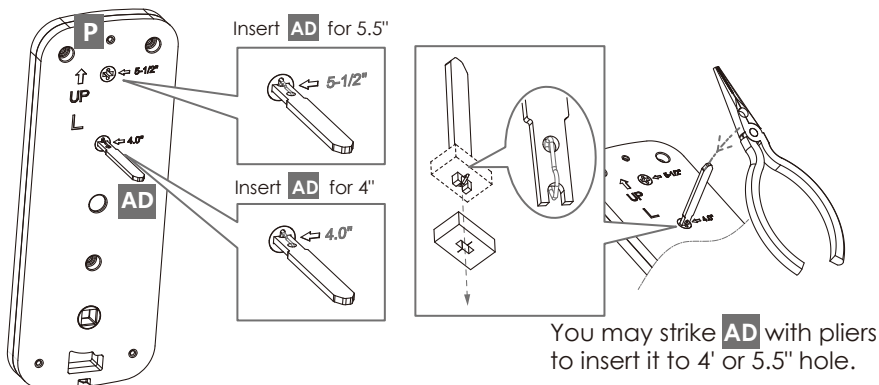

Select the correct side of the interconnection gear.

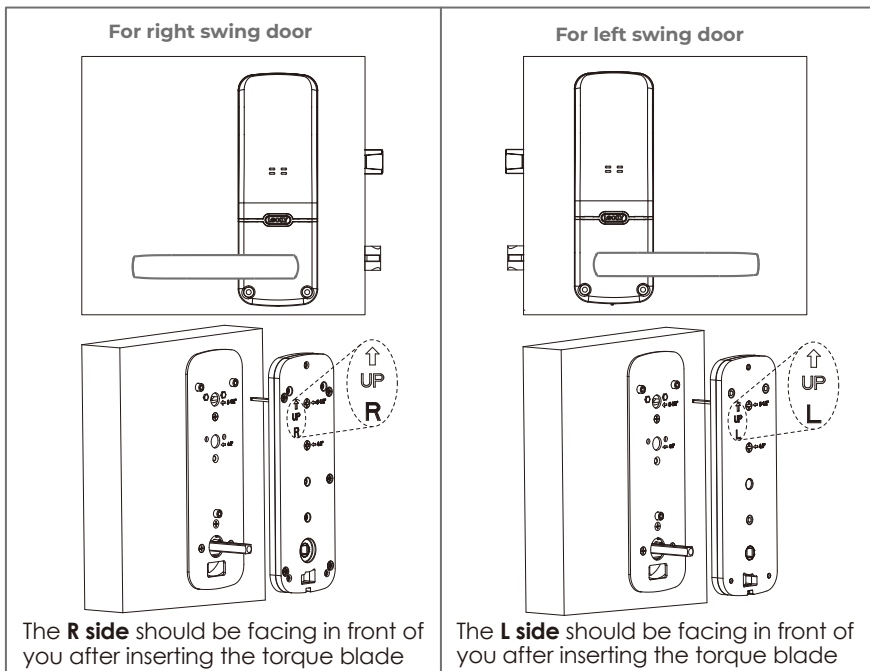

- 7 Install interconnection plate **P** onto door. Ensure the torque blade **AD** is inserted horizontally to the deadbolt. The spindle must pass through the plate. Secure the plate with screws **M** .

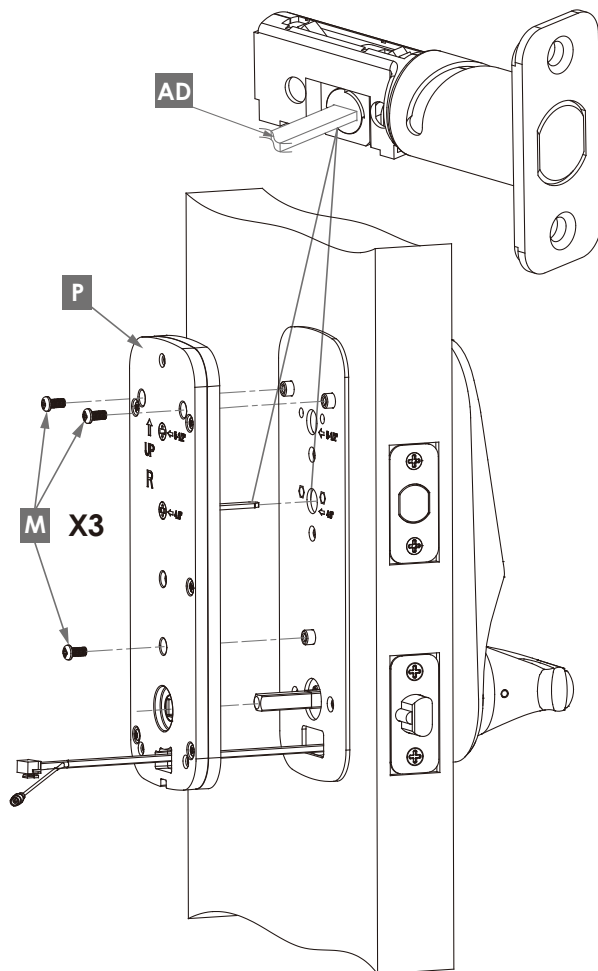

Step 6

INSTALLING INTERIOR ASSEMBLY (N)

- 1 Connect cable **A1** to **A2** by hand. Plug **B1** into **B2**, match red side of plug with red on socket - insert tightly.

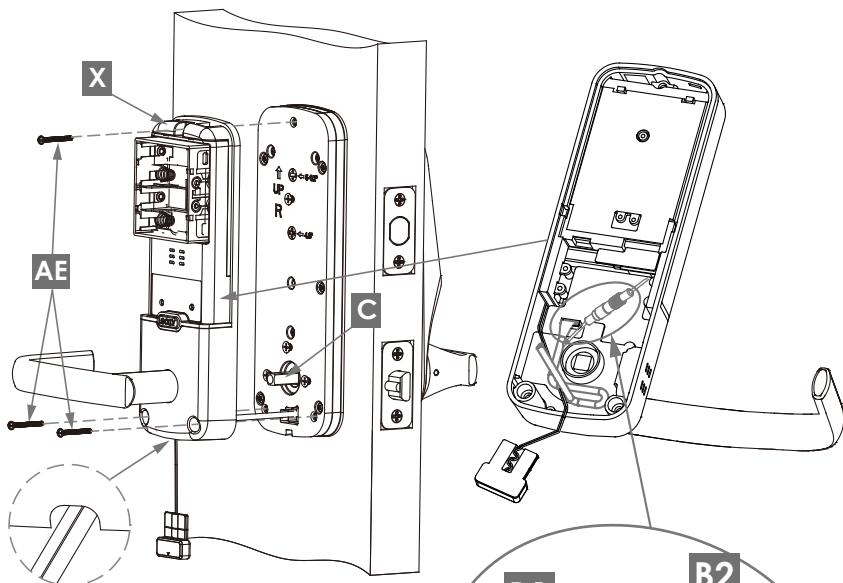

Secure the lock interior with 3 screws **AE**

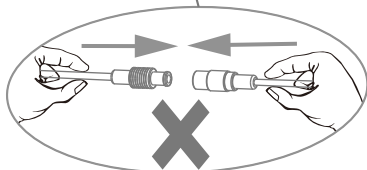
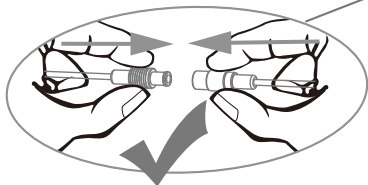
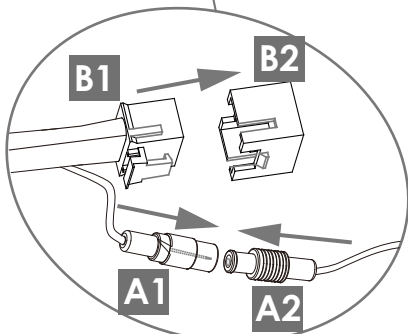
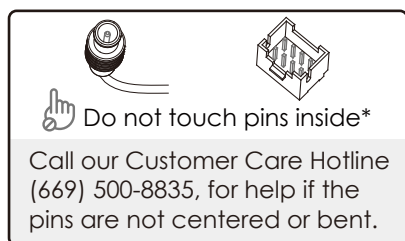

- 2 Align the spindle **C** to the lock interior and attach the Interior lock to the interconnection plate.

Gently push some of the excess cable through the rectangular hole into the door.

Place the remaining cable inside the interior assembly and ensure it sits securely onto the interconnection plate gear.

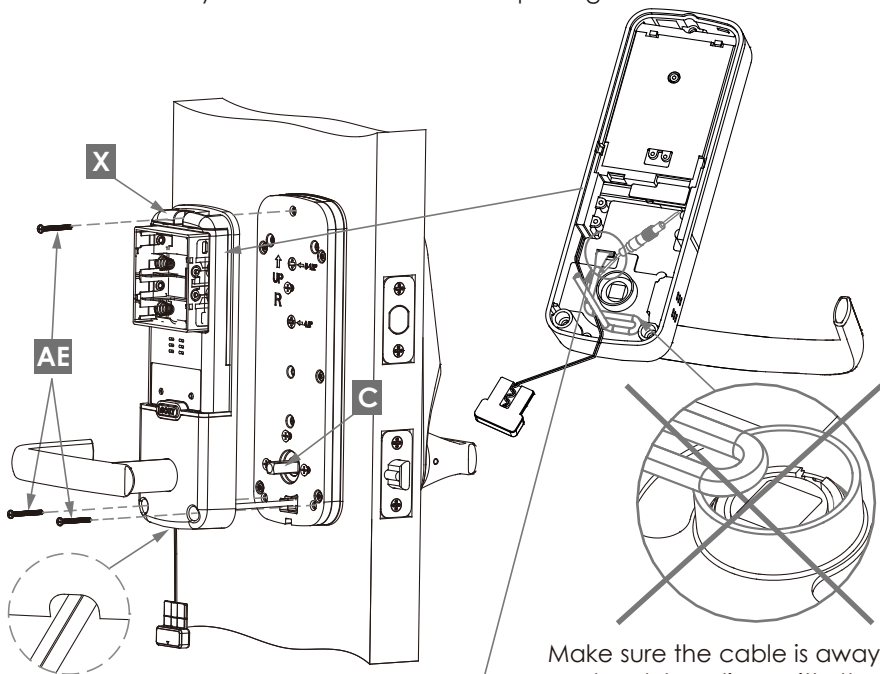

Make sure the cable is away and not tangling with the spindle **C**

IMPORTANT:

If you need to disconnect this cable, use a screwdriver to hold down the tab before carefully unplugging. DO NOT FORCE as this may result in damaging the lock.

Install Cable



Remove Cable

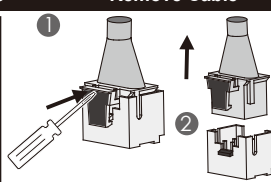

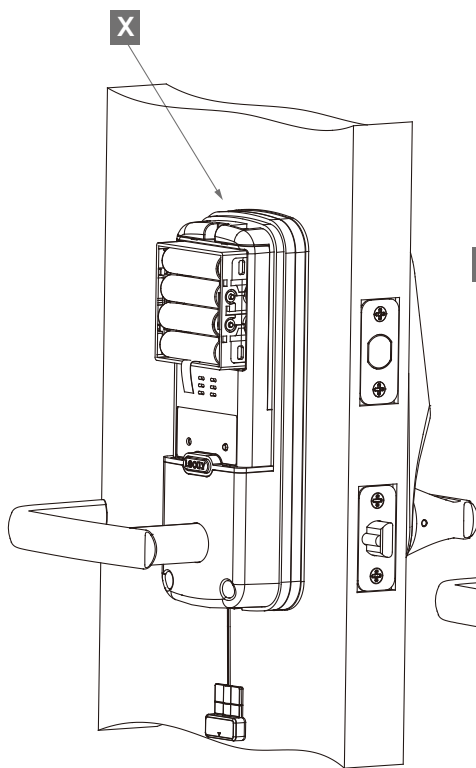

3

Insert 8 AA batteries into the lock by aligning the positive (+) and negative (-) markings on the batteries to the battery chamber.

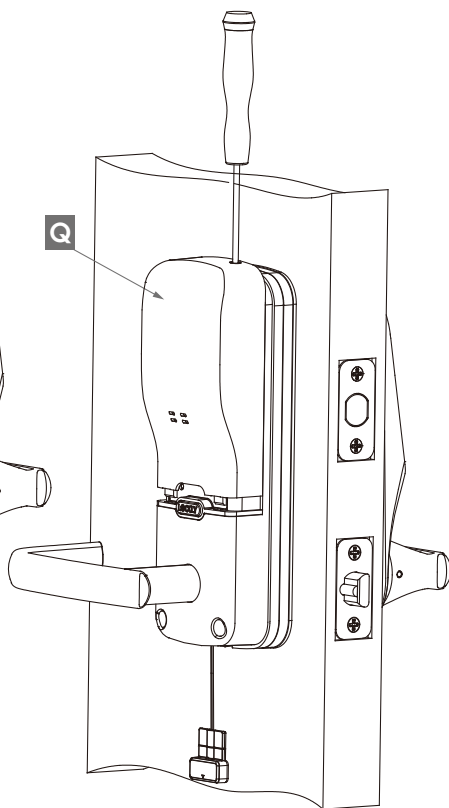

4

Secure the battery by sliding the cover **Q** over the lock and turning the screw clockwise on top until tight.

Do not mount (install) door sensors yet. You will install in step 9.

About door sensors

Door sensors provide real-time door condition status, such as the ability to verify if the door is securely closed. It also sends push notifications to your phone whenever your door opens and enables voice control.

Lockly Guard™ Vision Duo (698D) comes with a pre-wired door sensors consisting of two parts:

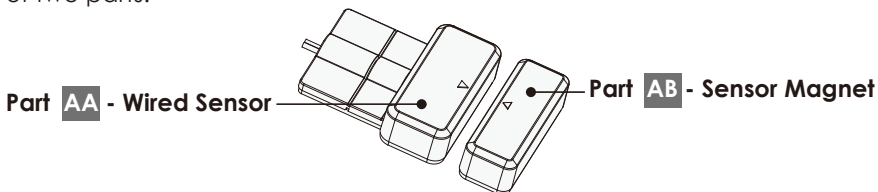

TIP : Lockly door sensors comes in Grey (PGA061) and Matte Black (PGA062) that can be ordered through our customer hotline: (855) 562-5599 or by email: prosales@lockly.com

Removal of Sensor (optional)

There may be circumstances where the sensor cannot be installed because of molding/door limitations or is not aesthetically desirable. The sensor wired to the lock is removable by carefully pulling its connector from the circuit board. **If removed, some features and functionality will not be available, such as real-time condition status.**

When you are installing the door sensors, make sure the arrow of the wired sensor **AA** is placed next to the arrow of the sensor magnet **AB** as close as possible.

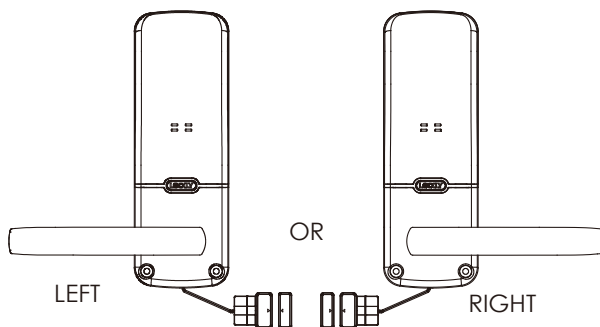

IMPORTANT: Do not install the sensor close to the strike plate .

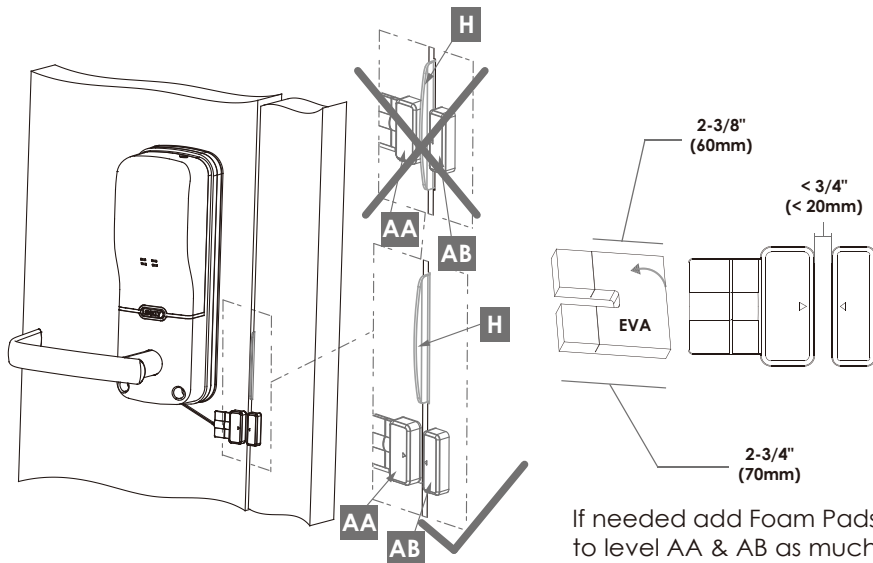

The interior assembly comes with the pre-installed wired door sensor setup for a right/left swing doors with 2-3/4" (70mm) backset*.

Trim excess part **e** for doors with 2-3/8" (60mm) backset as shown below.

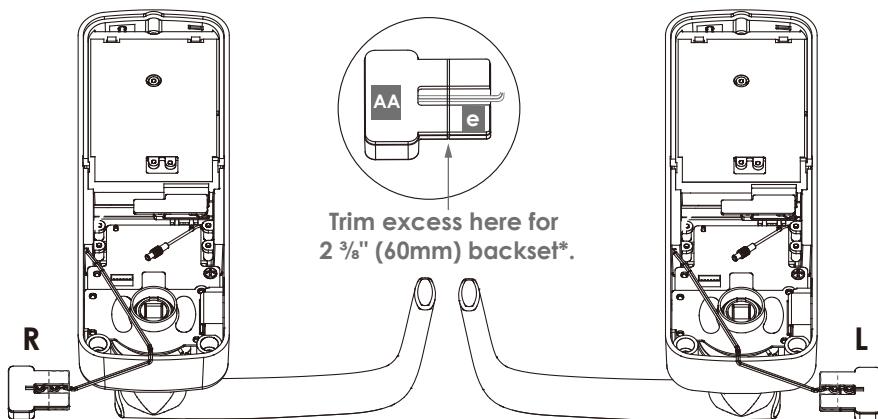

***Backset - measure the distance of the door edge to the center of the door hole.**

Make sure you install the Door Sensor indoors on a clean and dry surface. Gently wipe the surface of your door and door frame where you wish to install the Door Sensor and make sure it's dry before installing.

Keep the Door Sensor away from direct sunlight, high heat locations and large metal objects that may interfere with wireless signals.

DO NOT INSTALL THE SENSORS YET

Step 8

INSTALLING THE DOOR STRIKE

It is recommended that you use the included strike plate. However, if you find the deadbolt and latchbolt works with your existing strike plate free of any binding or resistance you can use it. Regardless of which strike plate used, deadbolt and latchbolt needs to operate smoothly, free of any binding or resistance. Adjust appropriately as needed.

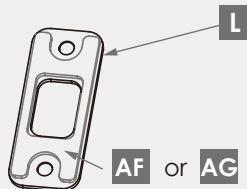
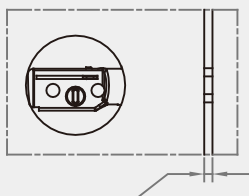
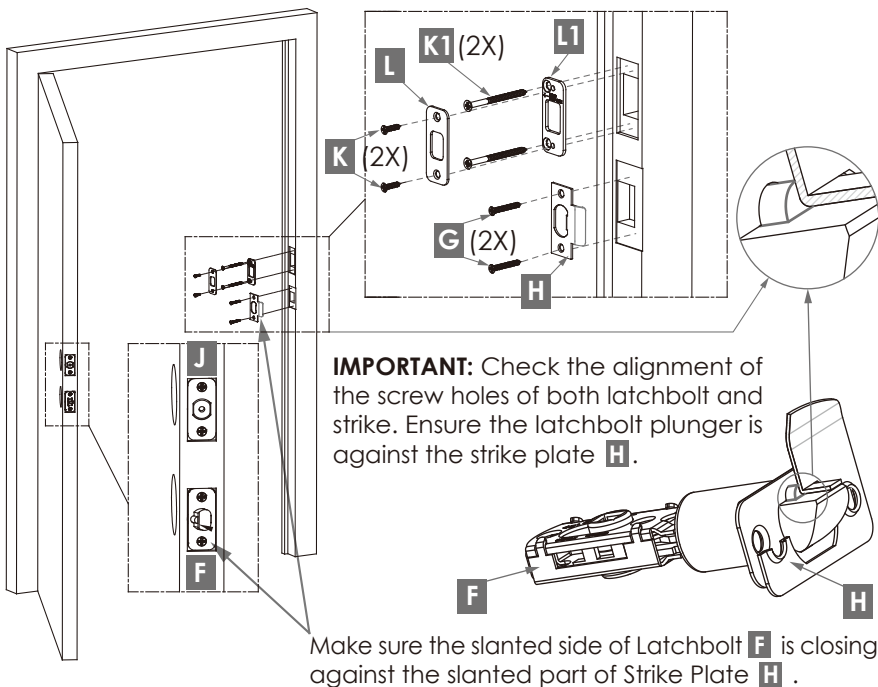

Before fixing it on to door frame, check the gap between door and door frame should be less than 4.5mm. Attach **AF** (2mm) or **AG** (3mm) to the strike plate **L** to reduce gap, if necessary.

Make sure you have prepared the door sensors for installation according to Step 7

- 1** Peel off the paper layer of the adhesives from the back of the wired sensor **AA**.
- 2** Position the wired sensor **AA** to the edge of the door, avoiding the door strike plate. Attach and secure with the adhesives.

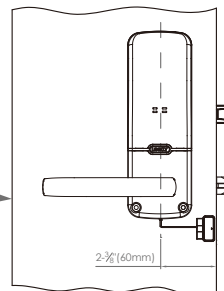
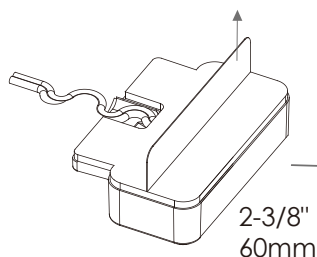
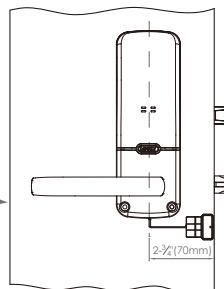
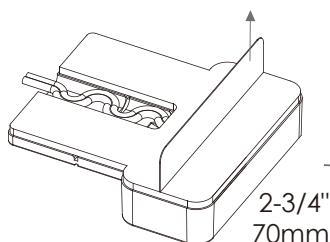

- 3** Close the door. Before you peel off the paper layer of the adhesives from the sensor magnet **AB**, align the arrow with the wired sensor **AA**. Install **AB** on to door frame.

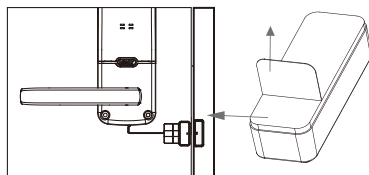

NOTE:

The arrows must be aligned or as closed as possible (less than 3/4"). If needed, adjust the position of the sensor magnet using provided foam pads to ensure the Lockly logo blinks red when door opens or closes.

Step 10

DOWNLOAD LOCKLYPRO APP & UNIQUE ACTIVATION CODE

Congratulations! You have completed the Lockly Guard™ Vision Duo (698D) physical lock installation. To complete your setup, download the LocklyPro app from the iOS or Google Play app Store and follow on-screen instructions.

Scan or visit
Locklypro.com/app



Additionally, you'll need the Activation Card with unique pre-paired QR code to your lock. The card is located in the packaging that your lock came in. This QR code can also be found at the bottom of Vision Connect Hub. Please keep it in a safe place—this QR code is required to complete the setup and will be required if you lose your smartphone or access code.



IMPORTANT: Without the QR code you will not be able to reset your lock

The Vision Connect Hub connects directly to your Wi-Fi router using the provided LAN cable. Choose an appropriate location for the hub for optimum performance (see below). For optimum connectivity, it is recommended to set up the hub **LESS than 100 feet (30 meters)** away from the lock, and **elevated 3 feet (1 meter)** off the ground.

During the setup process position yourself between the lock and the Vision Connect hub—ideally no more than 100 feet (30 meters) apart. Ensure your iOS or Android™ device has both Bluetooth® and Wi-Fi enabled

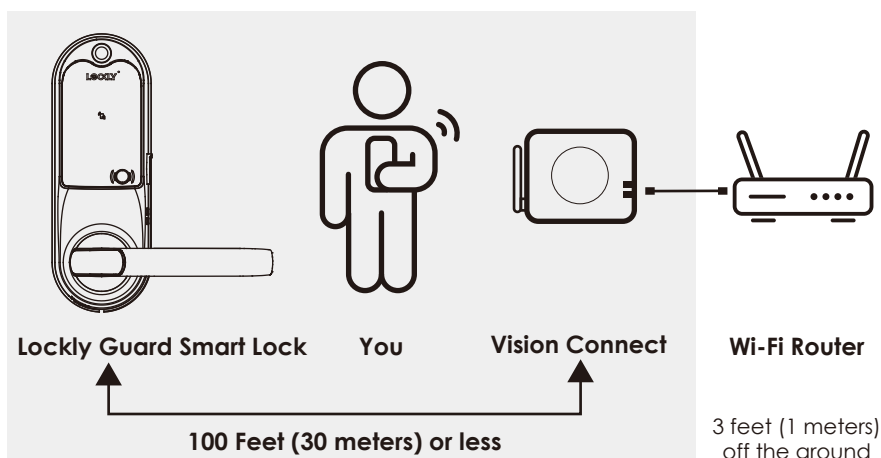

TIP: Sometimes distances between hub and lock can vary due to circumstances. If you are having difficulty setting up optimal range of 100/ft or less, we're here to help. Call our customer care team: (855) 562-5599 or by email: prosales@lockly.com, or visit <http://locklypro.com/support> for suggestions and troubleshooting tips.

Plug the Wi-Fi Hub into the 5V 1A USB AC adapter and plug the AC adapter to your wall socket.

To enable video doorbell, live monitoring and voice control with Hey Google, you will need to setup the included Vision Connect Wi-Fi hub with the Lockly Guard™ deadbolt smart lock + video doorbell.

VISION CONNECT OVERVIEW

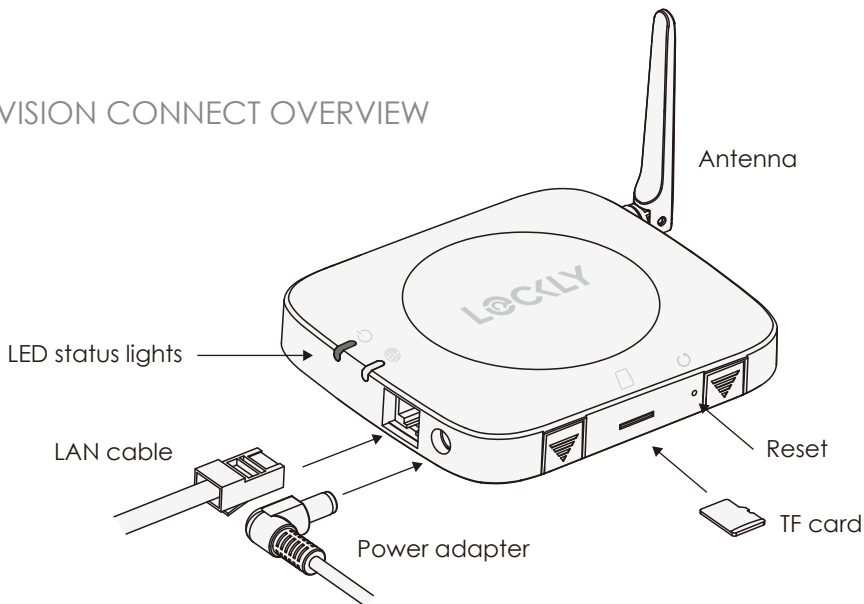

Once you have confirmed that your Wi-Fi Hub is ready to connect to your lock, open the LocklyPro App from your smartphone. **Make sure you are standing between the Wi-Fi hub and Lockly Guard smart lock**, then Add New Device and follow the on screen instructions.

IMPORTANT: Vision Connect stores recorded video on the included TF card. Although the TF card is discrete, it is recommended to locate it in a discrete or secure area to protect your privacy and video recordings.

Ensure the TF card that comes with Vision Connect is properly inserted.

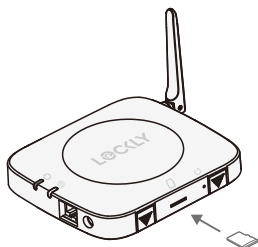

TF card (included, inserted)

Connect LAN cable to closest Wi-Fi router to the Lockly Guard™ lock (<100ft).

Always keep the Antenna on UP position

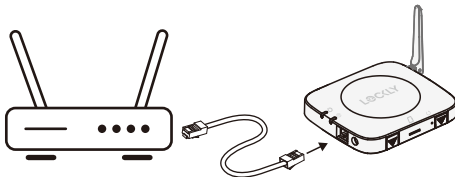

LAN cable (S) (included)

Connect power cable and plug USB power adapter into outlet.

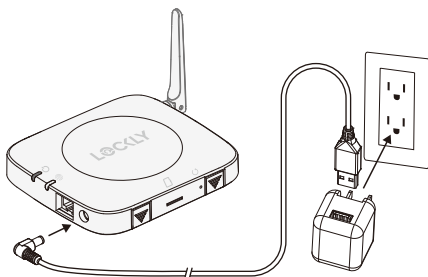

Wait 2 minutes for hub to self calibrate. Once LEDs turn RED and blink yellow.

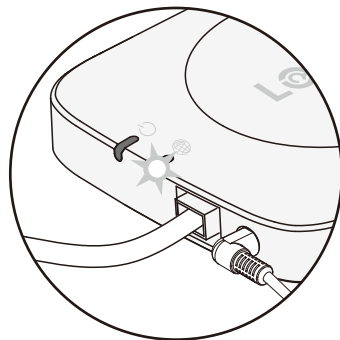

Vision Connect is now ready to connect to your iOS or Android™ device.

See troubleshooting on next page if LEDs do not meet the described conditions.

Step 12

PAIR LOCKLY GUARD™ VISION LOCK TO APP

Launch the **LocklyPro App** and select "**add a new device**", then select Lockly Guard™ Vision Duo (698D). You will be prompted to scan the QR code from the Activation Card or Vision Connect Hub (located at the bottom).

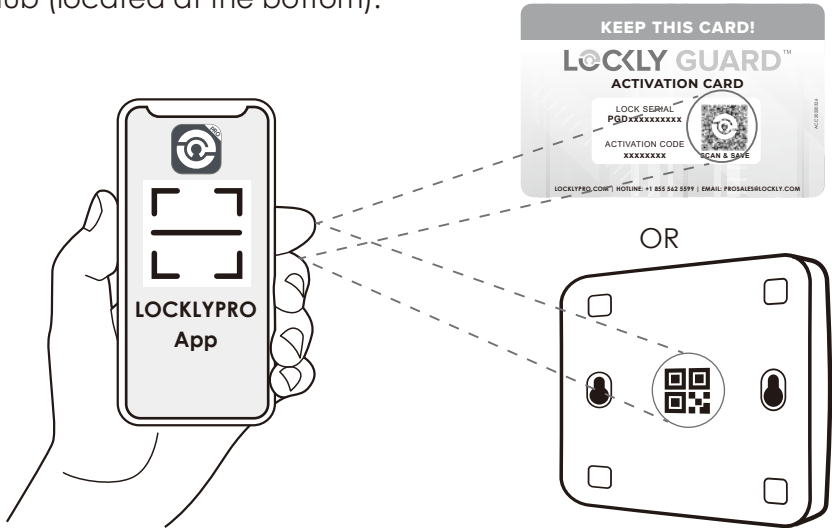









IMPORTANT: Make sure your Lockly Guard™ Vision has the latest firmware. Allow updates and follow instructions if prompted. For more info, visit: <http://www.locklypro.com/support>

NOTE: Power interruption during firmware update may damage the Vision Connect hub. Do not interrupt or turn the power off while firmware update is in progress.

TIPS:

- Remember to register for warranty.
- Allow your mobile phone to receive push notifications.
- Send in-app feedback if you encounter any issues while using the App.
- If you are having difficulty scanning the QR code, we're here to help. Call our customer care team: (855) 562-5599, or visit <http://locklypro.com/support> for suggestions and troubleshooting tips.

	LED INDICATORS	HUB	STATUS
During Setup	Solid red ON	After connecting LAN cable and power adapter, wait for 2mins for Vision Connect to self calibrate.	Power ON/ Successfully paired
	Yellow slow blinking	 READY TO CONNECT	Network connected
	If you experience any of the following, power down and disconnect hub, repeat connection process		
	Red slow blinking		Pairing / Network NOT yet connected
	Red fast blinking		Pairing unsuccessful
	Yellow OFF		Router or LAN cable issue NO network connection
	Blinking red goes to blue, then turns OFF		Resetting
During Firmware Update	Blue slow blinking		Update in progress*
	Blue ON		Update Successful
	Blinking from red to blue		Update has failed

*Power interruption during firmware update may damage the Vision Connect hub. Do not interrupt or turn the power off while firmware update is in progress.

Step 14

CONNECTING YOUR LOCKLY GUARD™ VISION DUO (698D)

The App will take you through the following steps, make sure the smart lock has been properly installed. You will need your activation card that is included in the box to proceed.

ADD NEW DEVICE

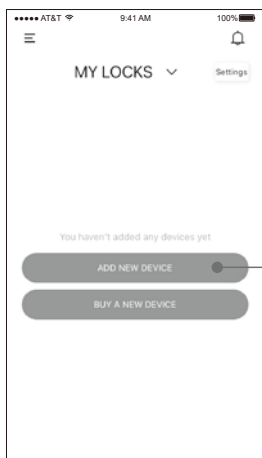

Select A Device



Connect Vision Connect Hub

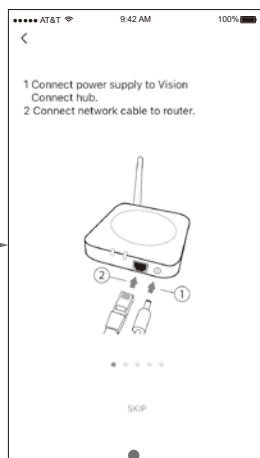

Connect Vision Connect Hub

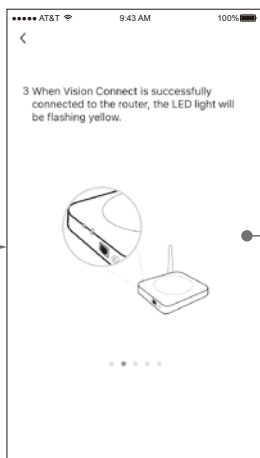

Connect Vision Connect Hub

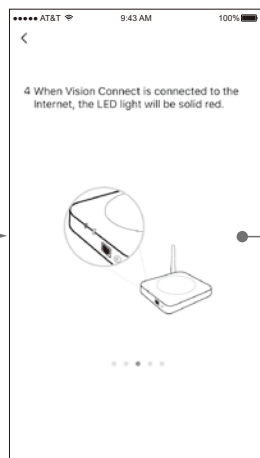

Turn to the next page

Step 14 continued CONNECTING YOUR LOCKLY GUARD™ VISION DUO (698D)

Find the Activation Card

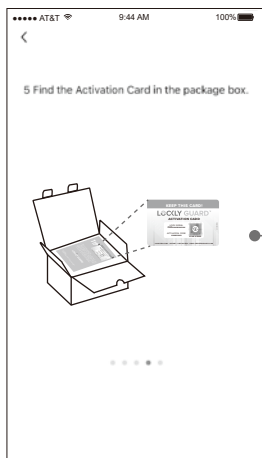

Scan the QR Code

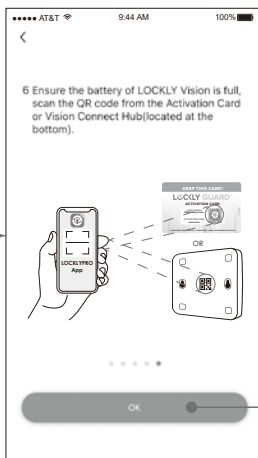

Scan the QR Code

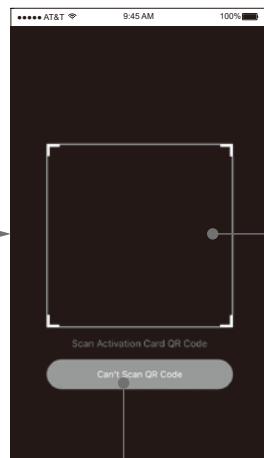

If you can't scan LOCK SERIAL, Then enter manually

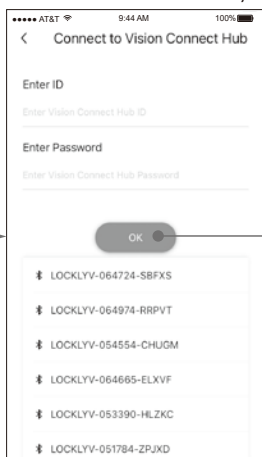

Input Activation Code

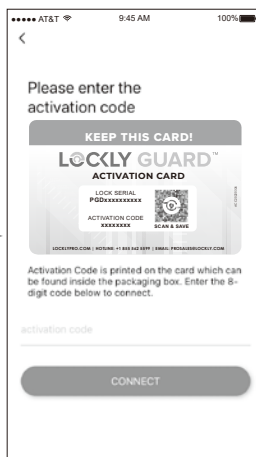

Turn to the next page

Step 14 continued CONNECTING YOUR LOCKLY GUARD™ VISION DUO (698D)

Set the Admin Code

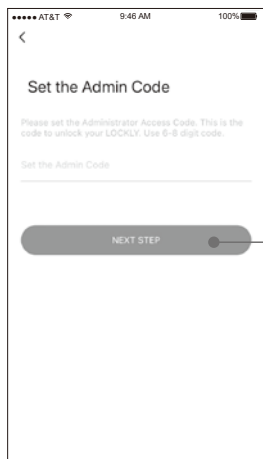

Match Admin Code

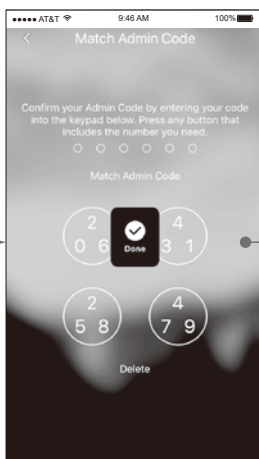

Successfully Connected

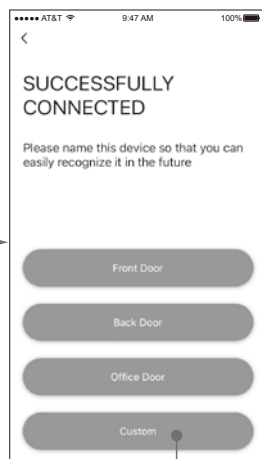

Successfully Connected

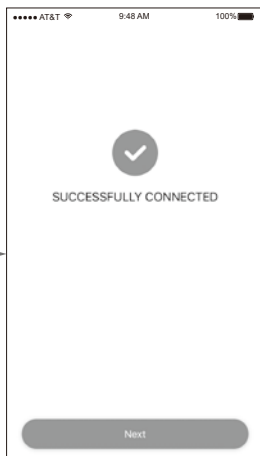

Congratulations!
Your Lockly Guard™ Vision Duo (698D) is now - set up.

You may proceed to Add the Door Sensors.

FCC Warning:

This device complies with Part 15 of the FCC Rules. Operation is subject to the following two conditions: (1) This device may not cause harmful interference, and (2) this device must accept any interference received, including interference that may cause undesired operation.

NOTE 1: This equipment has been tested and found to comply with the limits for a Class B digital device, pursuant to part 15 of the FCC Rules. These limits are designed to provide reasonable protection against harmful interference in a residential installation. This equipment generates, uses and can radiate radio frequency energy and, if not installed and used in accordance with the instructions, may cause harmful interference to radio communications. However, there is no guarantee that interference will not occur in a particular installation. If this equipment does cause harmful interference to radio or television reception, which can be determined by turning the equipment off and on, the user is encouraged to try to correct the interference by one or more of the following measures:

- Reorient or relocate the receiving antenna.
- Increase the separation between the equipment and receiver.
- Connect the equipment into an outlet on a circuit different from that to which the receiver is connected.
- Consult the dealer or an experienced radio/TV technician for help.

NOTE 2: Any changes or modifications to this unit not expressly approved by the party responsible for compliance could void the user's authority to operate the equipment.

FCC Radiation Exposure Statement

This equipment complies with FCC radiation exposure limits set forth for an uncontrolled environment. It should be installed and operated with minimum distance 20cm between the radiator & your body.

IC WARNING

This equipment contains licence-exempt transmitter(s) that comply with Innovation, Science and Economic Development Canada's licence-exempt RSS(s). Operation is subject to the following two conditions:

- (1) This device may not cause interference.
- (2) This device must accept any interference, including interference that may cause undesired operation of the device.

L'émetteur/récepteur exempt de licence contenu dans le présent appareil est conforme aux CNR d'Innovation, Sciences et Développement économique Canada applicables aux appareils radio exempts de licence. L'exploitation est autorisée aux deux conditions suivantes:

1. L'appareil ne doit pas produire de brouillage;
2. L'appareil doit accepter tout brouillage radioélectrique subi, même si le brouillage est susceptible d'en compromettre le fonctionnement.

IC Radiation Exposure Statement

This equipment meets the exemption from the routine evaluation limits in section 2.5 of RSS-102. It should be installed and operated with a minimum distance of 20cm between the radiator and any part of your body.

Cet équipement est conforme à l'exemption des limites d'évaluation habituelle de la section 2.5 de la norme RSS-102. Il doit être installé et utilisé à une distance minimale de 20 cm entre le radiateur et toute partie de votre corps.



WARNING: This product can expose you to chemicals including Lead, which is known to the State of California to cause cancer. For more information go to www.P65Warnings.ca.gov.

INSTALLATION OVERVIEW & PARTS LIST

This lock can be installed for both right swing and left swing doors. The lock ships ready for a right swing door installation. If you wish to change the orientation of the lock for a Left Swing door, follow instructions on Installation Guide (**Step 2**).

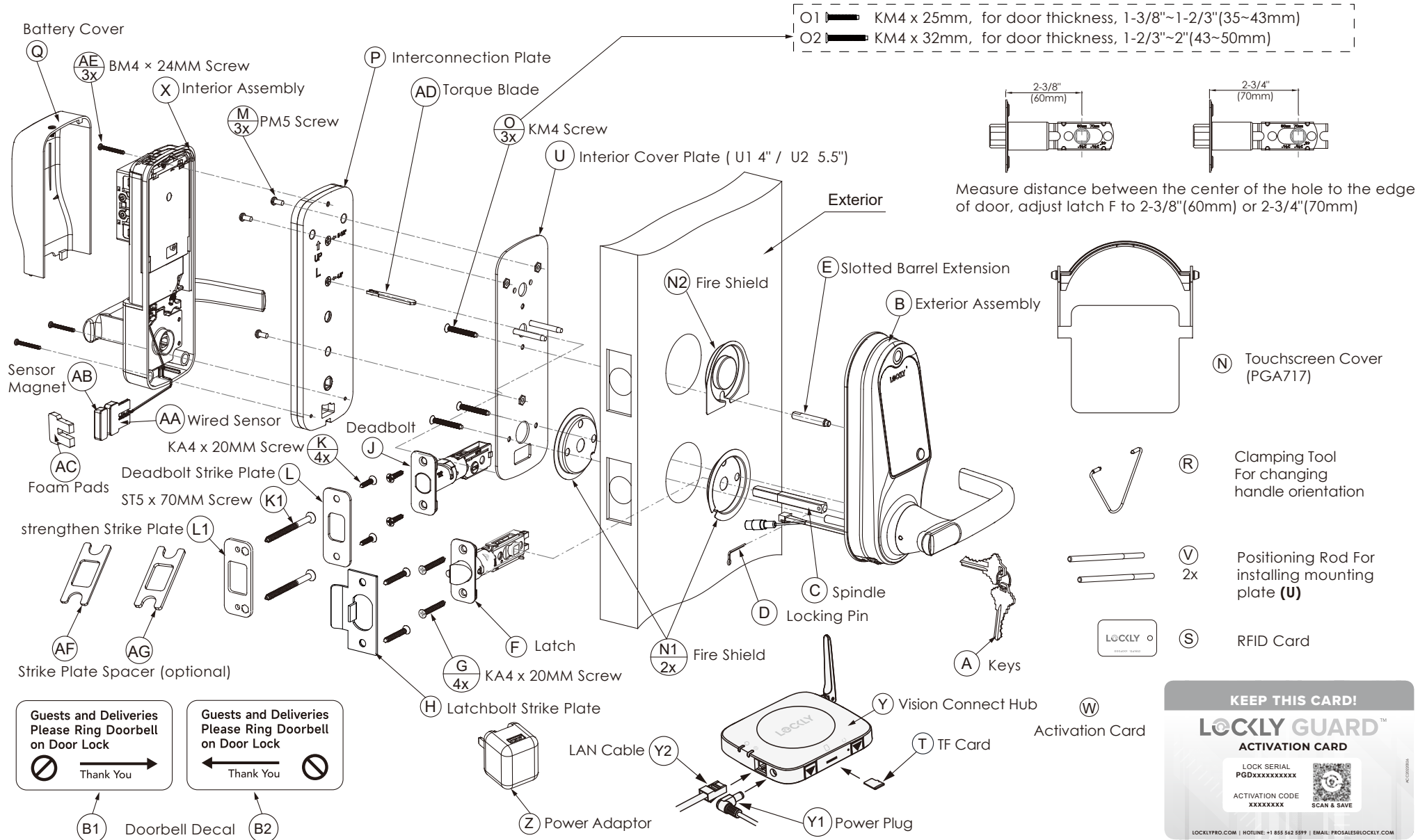

KEEP THIS CARD!

LOCKLY GUARD™
ACTIVATION CARD

LOCK SERIAL
PGDxxxxxxxxx

ACTIVATION CODE
xxxxxxx



SCAN & SAVE

LOCKLYPRO.COM | HOTLINE: +1 855 542 5599 | EMAIL: PROSALES@LOCKLY.COM

WAIT.

IMPORTANT NOTES

- Lockly Guard installs differently from other door locks. Professional installer(s) and locksmiths must read and follow Lockly Guard installation and user manuals to prevent damaging the product. Failure to do so may also result in the smart lock not responding correctly to lock and unlocking commands and will require re-installation.
- This product is recommended for residential use. Please check your office building or property management policies and regulations before installation.

DO NOT RETURN to the stores. Please call our customer care team: (855) 562-5599 to help you with any issues or concerns you might have.

LOCKLY GUARDTM



FOR COMMERCIAL USE & PROFESSIONAL INSTALLATION

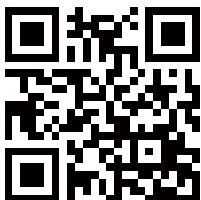

We're here to help!
prosales@lockly.com
locklypro.com/support

© Copyright 2022 Lockly All rights reserved

US Patent NO. US 9,881,146 B2 | US Patent NO. US 9,853,815 B2 | US Patent NO. US 9,875,350 B2 | US Patent NO. US 9,665,706 B2 | US Patent NO. US 11,010,463 B2 | AU Patent NO. 2013403169 | AU Patent NO. 2014391959 | AU Patent NO. 2016412123 | UK Patent NO. EP3059689B1 | UK Patent NO. EP3176722B1 | Other Patents Pending

The Bluetooth® word mark and logos are registered trademarks owned by the Bluetooth SIG, Inc. , and any use of such marks by Lockly is under license. Other trademarks and trade names are those of their respective owners. Google, Android and Google Play are trademarks of Google LLC.